

# ZL12(24)-RZ1030-4

## DC Motor Peristaltic Pump



- ◆ Compact size compact structure, low power consumption
- ◆ Easy replace tubing, various standard tube sizes
- ◆ 12V or 24V DC motor equipped, easy control
- ◆ OEM support
- ◆ Widely used in medical, environmental, industrial analyzers

### Roller Mounting Steps

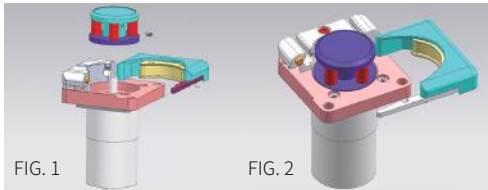

Install the roller parts (purple part) vertically downwards as shown in Figure 1 Flat installation to make sure purple part share the same plane with the pink part.

As shown in Figure 2, the roller is perfectly installed.

Note : Refer to page P37 for pump tube installation [RZ1030-4]

### Dimension (unit:mm)

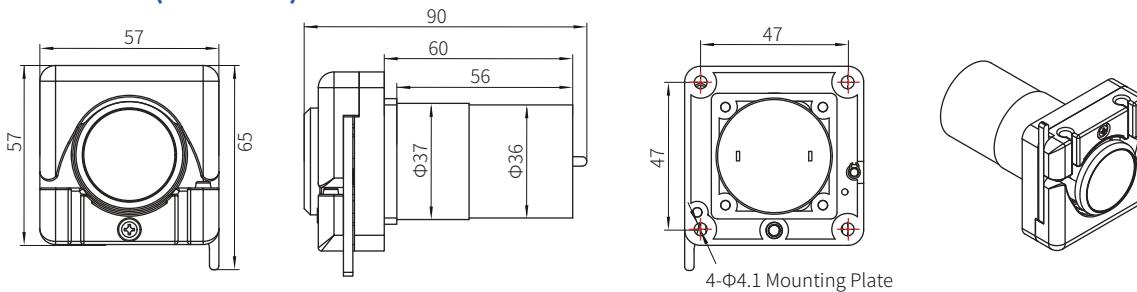

### Technical Parameter

Model No.	Motor Type	Input Voltage	Rated Current	Power	Speed	Net Weight	Working Environment	Max.DB
ZL12-RZ1030-4	DC motor	12V	0.04~0.2A	15W	100/200/300 rpm	429g	Temp. 0~40°C Humidity <80%	70dB
ZL24-RZ1030-4		24V				427g		

### Flow Rate Table(300 rpm for this test)

Tubing	Rubber tube															Silicone tube		
	ID*WT(mm)	0.64*0.8	0.76*0.8	0.89*0.8	1.02*0.8	1.14*0.8	1.30*0.8	1.42*0.8	1.52*0.8	1.65*0.8	1.85*0.8	2.06*0.8	2.29*0.8	2.54*0.8	2.79*0.8	1*1	2*1	3*1
ZL12-RZ1030-4 (ml/min)	6	9	10	13	14	22	28	31	37	46	55	58	95	105	15	47	122	
ZL24-RZ1030-4 (ml/min)	10	13	16	22	24	32	36	41	46	54	67	96	112	125	23	86	140	

Note: Test under room temperature 20°C and no external pressure (water), flow rate may vary from different media, condition, pressure, humidity, temperature etc. The date for reference only.